



# DIN41612

## CONNECTORS



General Information	Page 1
How to place an order with Compel	Page 1
Features	Page 2
Coupling Types	Page 2
Terminations	Page 3
Options	Page 3
Types Summary	Page 4
Types B and B/2 Male	Page 5
Type B Female	Page 6
Types C, C/2 and C/3 Male	Page 7
Type C Female	Page 8
Types C/2 and C/3 Female	Page 9
Types C, C/2 and C/3 Female Press-Fit	Page 10
Types M and M/2 Male	Page 11
Types M and M/2 Female	Page 12
Type Q Male	Page 13
Type Q/2 Male	Page 14
Types Q and Q/2 Female	Page 15
Type R Male	Page 16
Type R/2 Male	Page 17
Types R and R/2 Female	Page 18
Type M Reversed Male	Page 19
Type M Reversed Female	Page 20
Male and Female Power Contacts for DIN 41612 Type M	Page 21
DIN 41612 Type M Coaxial Inserts (50 Ohm)	Page 22
DIN 41612 Type M Coaxial Inserts (75 Ohm)	Page 23
Board Drillings	Page 24
Insertion Tools for Press-Fit Connectors	Page 25
Part Number Index	Page 26

---

## General Information

---

The Eurocard Type of Connector in accordance with the Standards DIN 41612 and IEC 630-2, is produced by Compel in Standard and Reversed types.

The contacts arrangement of the connectors can be either fully or partially loaded with different terminations and finishes.

All of these facts allow the User to choose which type he requires for optimal use from the point of view of Quality/Cost.

The version with Press-Fit terminations can be particularly appreciated by the User for its reliability.

These types of connectors are used for the connection between the Cards and Back-Panels in electronic equipments.

---

## How to place an order with Compel

---

Simply indicate the relevant Part Number which you will find in the Catalogue. Please contact us should you have any requirement for materials, finishes or dimensions which differ from those given.

---

MECHANICAL

Number of contacts	12 ÷ 96
Terminations	Wire Wrap, PCB, Straight and Right Angle
Polarisation	Shape of the Connector
Insertion force	0.94 N max per contact
Withdrawal force	0.15 N min per contact
Temperature range	- 55°C ... +125°C

MATERIALS AND FINISHES

Insulation body	Polyester according to UL 94V-0
Male contact	Brass
Female contact	Phosphor bronze
Contacts finishes (Selective Au over Ni)	Class 1 min 500 matings according to IEC 603-2 and DIN 41612 Class 2 min 400 matings according to IEC 603-2 and DIN 41612 Class 3 min 50 matings according to IEC 603-2 and DIN 41612

ELECTRICAL

Working current	1.5 A at 20°C - 1.0 A at 70°C - 0.7 A at 100°C
Contact resistance	15 mohm max
Working voltage	300 V rms
Test voltage	1000 V rms
Insulation resistance	10 Mohm at 100 Vdc

COUPLING TYPES

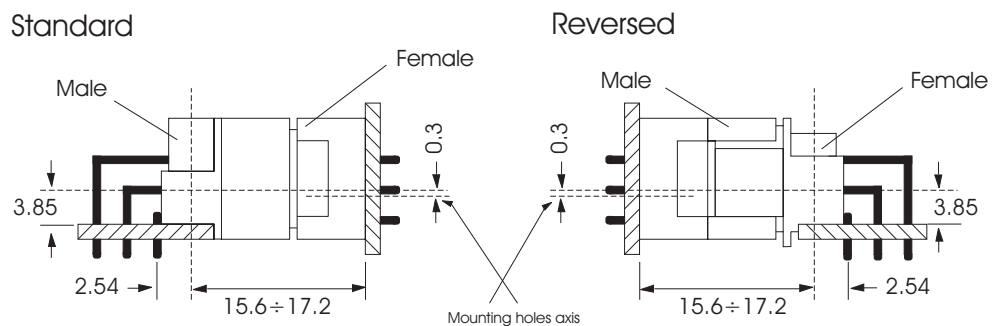

PCB solder terminations

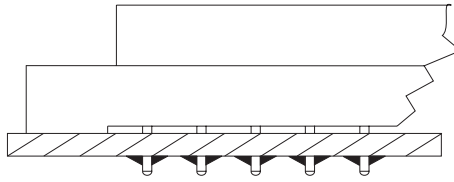

Wrap posts for automatic wiring

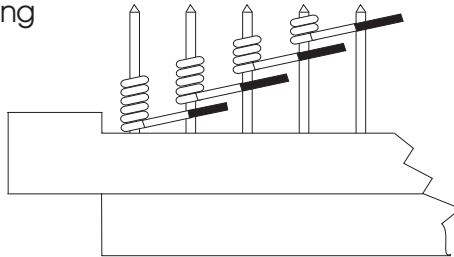

PRESS-FIT terminations

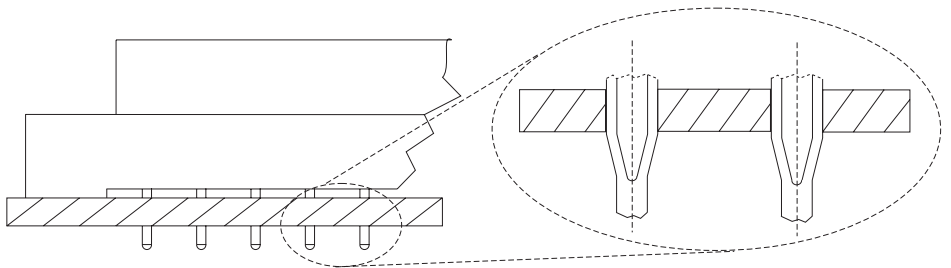

Mechanical and electrical features according to DIN 41611:

PCB holes metallization diameter:  $0.94 \div 1.09$  mm

PCB thickness:  $2.4 \div 4.8$  mm

Contact resistance: 1 mohm max

Recommended values for PCB holes (Press-Fit technique):

Hole:  $1.15^{+0.03}$  mm  
Cu:  $30 \div 60$   $\mu$ m  
Ni:  $5 \div 15$   $\mu$ m

Options

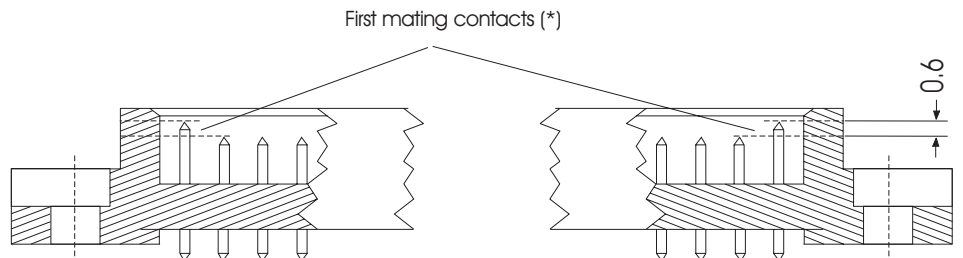

(\*) Other positions on request

DIN 41612 CONNECTORS: STANDARD COUPLING			MALE TERMINATIONS (mm)							FEMALE TERMINATIONS (mm)				
Type	Number of contacts	Arrang. of contacts	Solder		Wire Wrap	Press-fit				Solder		Wire Wrap		Press-fit
			2.9	4.5	13.0	5.3	13.2	17.8	20.0	2.9	4.5	13.0	17.0	5.3
B	32 x 2	Free	●							●	●	●	○	○
B/2	16 x 2	Free	●							○	○	○	○	○
C	32 x 3	Free	●							●	●	●	○	●
C/2	16 x 3	Free	●							●	●	●	○	●
C/3	10 x 3	Free	●							●	●	●	○	○
M	26 x 3	Free	●							●	●	○	○	●
	20 x 3	Free	●							○	○	○	○	●
	14 x 3	Free	●							●	●	○	○	●
	8 x 3	Free	●							○	○	○	○	●
M/2	10 x 3	Free	●							○	○	○	○	●
	4 x 3	Free	○							○	○	○	○	○

DIN 41612 CONNECTORS: REVERSE COUPLING			MALE TERMINATIONS (mm)							FEMALE TERMINATIONS (mm)				
Type	Number of contacts	Arrang. of contacts	Solder		Wire Wrap	Press-fit				Solder		Wire Wrap		Press-fit
			2.9	4.5	13.0	5.3	13.2	17.8	20.0	2.9	4.5	13.0	17.0	5.3
Q	32 x 2	Free	●	●	●	●	●	●	●	●				○
Q/2	16 x 2	Free	●	●	●	●	●	●	●	●				○
Q/3	10 x 2	Free	○	○	○	○	○	○	○	○				○
R	32 x 3	Free	●	●	●	●	●	●	●	●				○
R/2	16 x 3	Free	●	●	●	●	●	●	●	●				○
R/3	10 x 3	Free	○	○	○	○	○	○	○	○				○
MR	26 x 3	Free	○	○	○	●	●	●	●	●				○
	20 x 3	Free	○	○	○	●	●	●	●	●				○
	14 x 3	Free	○	○	○	●	●	●	●	●				○
	8 x 3	Free	○	○	○	●	●	●	●	●				○

● Available  
○ Not available at present

Connector Type	Number of Contacts	Arrangement of Contacts	Class 1 P/N	Class 2 P/N	Class 3 P/N	Notes
Type B Connector	64	a + b	350.081.203	350.081.203/2	350.081.203/6	
Male	32	a + b, np	350.081.202	350.081.202/2	350.081.202/6	
Right Angle Solder Pins	32	a	350.081.200	350.081.200/2	350.081.200/6	
	32	b	350.081.201	350.081.201/2	350.081.201/6	
	62 + 2c	a + b	350.081.300	350.081.300/2	350.081.300/6	
Type B/2 Connector	32	a + b	350.081.220	350.081.220/2	350.081.220/6	
Male	16	a + b, np	350.081.221	350.081.221/2	350.081.221/6	
Right Angle Solder Pins						

**Type B**

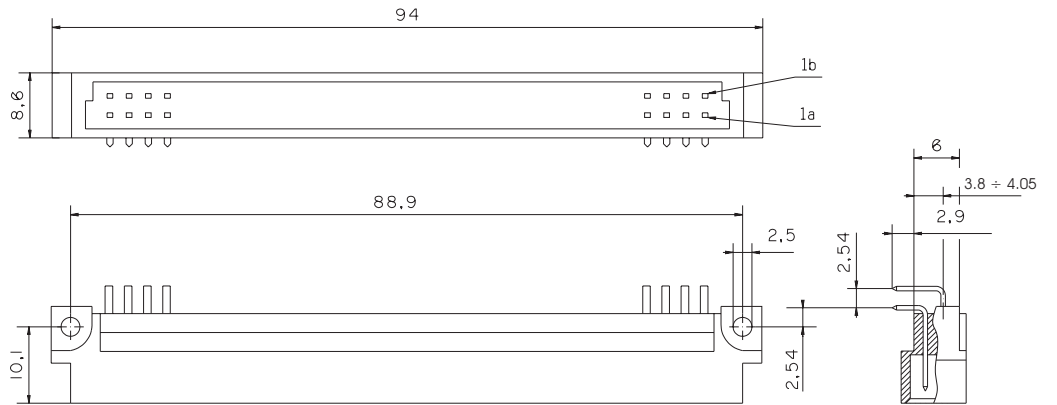

**Type B/2**

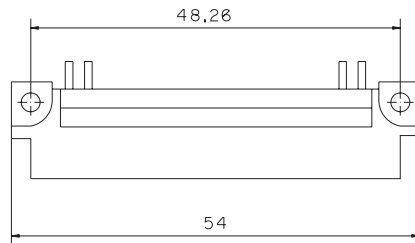

Connector Type	Number of Contacts	Arrangement of Contacts	Class 1 P/N	Class 2 P/N	Class 3 P/N	Notes
Type B Connector Female Straight Solder Pins L = 2.9 mm	64	a + b	350.080.243	350.080.243/2	350.080.243/6	
	32	a + b, np	350.080.242	350.080.242/2	350.080.242/6	
	32	a	350.080.240	350.080.240/2	350.080.240/6	
Type B Connector Female Straight Solder Pins L = 4.5 mm	64	a + b	350.080.283	350.080.283/2	350.080.283/6	
	32	a + b, np	350.080.282	350.080.282/2	350.080.282/6	
	32	a	350.080.280	350.080.280/2	350.080.280/6	
Type B Connector Female Straight Wrap Posts L = 13 mm	64	a + b	350.080.003	350.080.003/2	350.080.003/6	
	32	a + b, np	350.080.002	350.080.002/2	350.080.002/6	
	32	a	350.080.000	350.080.000/2	350.080.000/6	

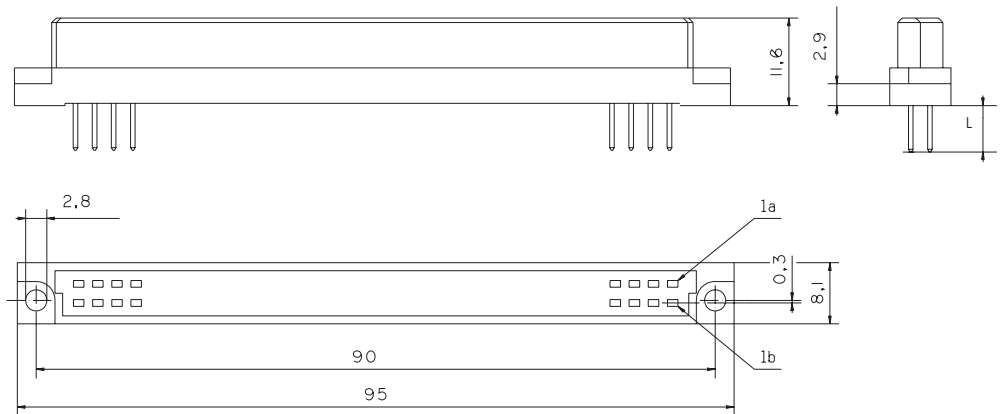

Connector Type	Number of Contacts	Arrangement of Contacts	Class 1 P/N	Class 2 P/N	Class 3 P/N	Notes
Type C Connector	96	a + b + c	350.081.210	350.081.210/2	350.081.210/6	(*)
Male	64	a + c	350.081.211	350.081.211/2	350.081.211/6	
Right Angle Solder Pins	32	a + c, np	350.081.212	350.081.212/2	350.081.212/6	
	32	a	350.081.215	350.081.215/2	350.081.215/6	
	94 + 2c	a + b + c	350.081.311			
Type C/2 Connector	48	a + b + c	350.081.230	350.081.230/2	350.081.230/6	
Male	32	a + c	350.081.231	350.081.231/2	350.081.231/6	
Right Angle Solder Pins	16	a + c, np	350.081.232	350.081.232/2	350.081.232/6	
Type C/3 Connector	30	a + b + c	350.081.245			
Male	20	a + c	350.081.246			
Right Angle Solder Pins						

First mating contacts on request; please contact us

(\*) First mating contacts 1a - 32a

Type C

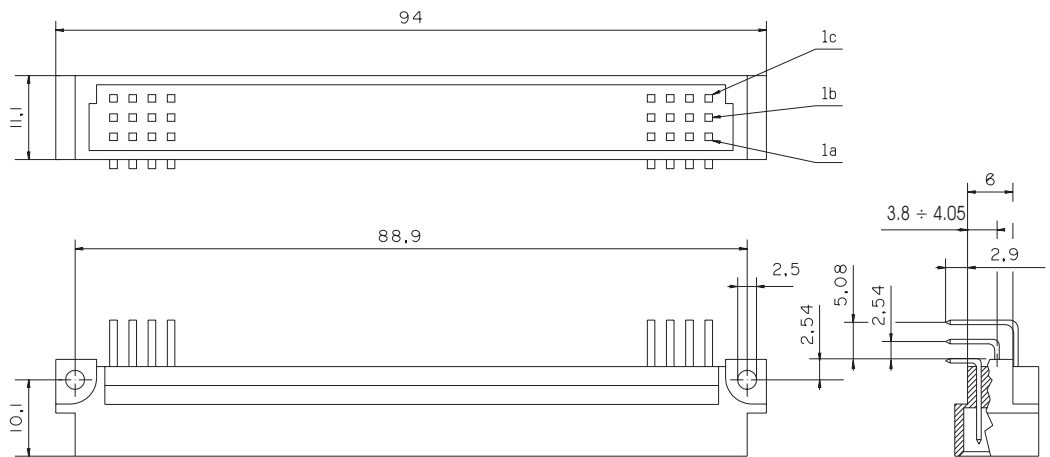

Type C/2

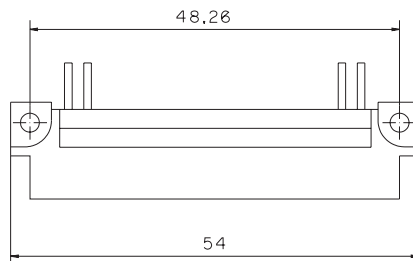

Type C/3

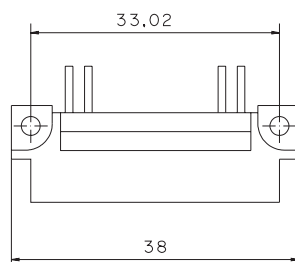



Connector Type	Number of Contacts	Arrangement of Contacts	Class 1 P/N	Class 2 P/N	Class 3 P/N	Notes
Type C Connector Female Straight Solder Pins L = 2.9 mm	96	a + b + c	350.080.250	350.080.250/2	350.080.250/6	
	64	a + c	350.080.251	350.080.251/2	350.080.251/6	
	32	a + c, np	350.080.252	350.080.252/2	350.080.252/6	
	32	a	350.080.255	350.080.255/2	350.080.255/6	
Type C Connector Female Straight Solder Pins L = 4.5 mm	96	a + b + c	350.080.290	350.080.290/2	350.080.290/6	
	64	a + c	350.080.291	350.080.291/2	350.080.291/6	
	32	a + c, np	350.080.292	350.080.292/2	350.080.292/6	
	32	a	350.080.295	350.080.295/2	350.080.295/6	
Type C Connector Female Straight Wrap Posts L = 13 mm	96	a + b + c	350.080.010	350.080.010/2	350.080.010/6	
	64	a + c	350.080.011	350.080.011/2	350.080.011/6	
	32	a + c, np	350.080.012	350.080.012/2	350.080.012/6	

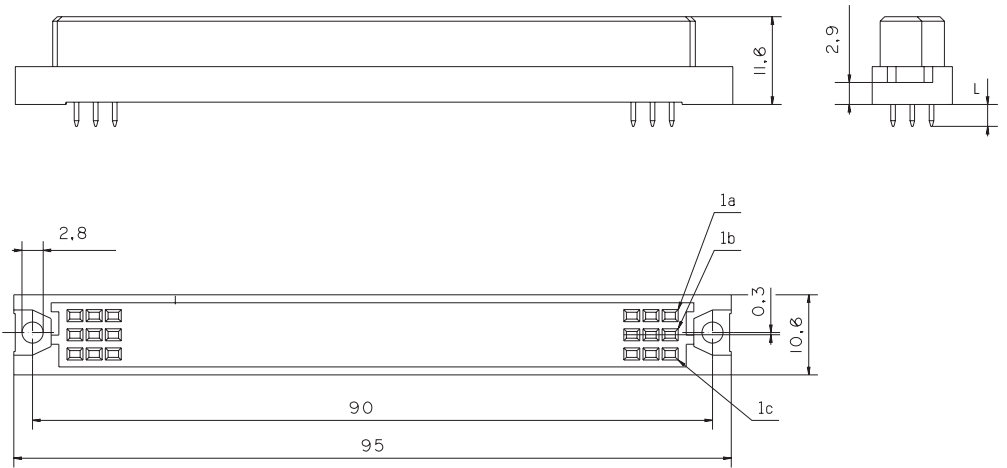

Connector Type	Number of Contacts	Arrangement of Contacts	Class 1 P/N	Class 2 P/N	Class 3 P/N	Notes
Type C/2 Connector Female Straight Solder Pins L = 2.9 mm	48 32 16	a + b + c a + c a + c, np	350.080.270 350.080.271 350.080.272	350.080.270/2 350.080.271/2	350.080.270/6 350.080.271/6	
Type C/2 Connector Female Straight Solder Pins L = 4.5 mm	48 32 16	a + b + c a + c a + c, np	350.080.310 350.080.311 350.080.312	350.080.310/2 350.080.311/2	350.080.310/6 350.080.311/6	
Type C/2 Connector Female Straight Wrap Posts L = 13 mm	48 32 16	a + b + c a + c a + c, np	350.080.030 350.080.031 350.080.032	350.080.030/2 350.080.031/2 350.080.032/2	350.080.030/6 350.080.031/6 350.080.032/6	
Type C/3 Connector Female Straight Solder Pins L = 2.9 mm	30 20	a + b + c a + c	350.080.335 350.080.336			
Type C/3 Connector Female Straight Solder Pins L = 4.5 mm	30 20	a + b + c a + c	350.080.325 350.080.326			
Type C/3 Connector Female Straight Wrap Posts L = 13 mm	30 20	a + b + c a + c	350.080.045 350.080.046			

Type C/2

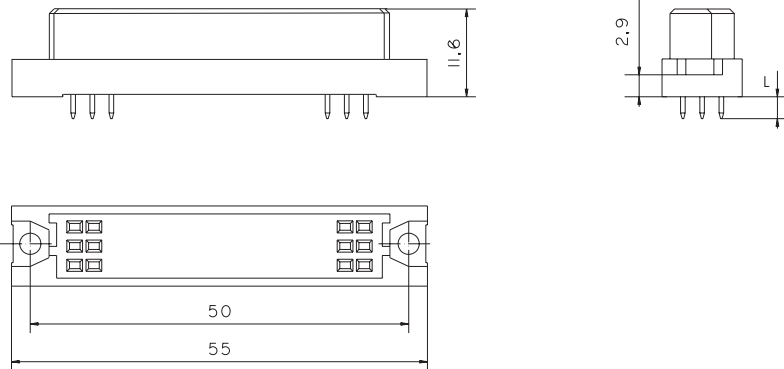

Type C/3

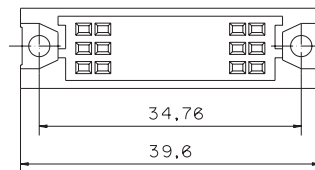

Connector Type	Number of Contacts	Arrangement of Contacts	Class 1 P/N	Class 2 P/N	Class 3 P/N	Notes
Type C Connector Female Press-Fit Technique	96	a + b + c	350.080.600			
	64	a + c	350.080.601			
	32	a + c, np	350.080.602			
Type C/2 Connector Female Press-Fit Technique	48	a + b + c	350.080.616			
	32	a + c	350.080.617			
Type C/3 Connector Female Press-Fit Technique	30	a + b + c	350.080.610			
	20	a + b	350.080.611			

Type C

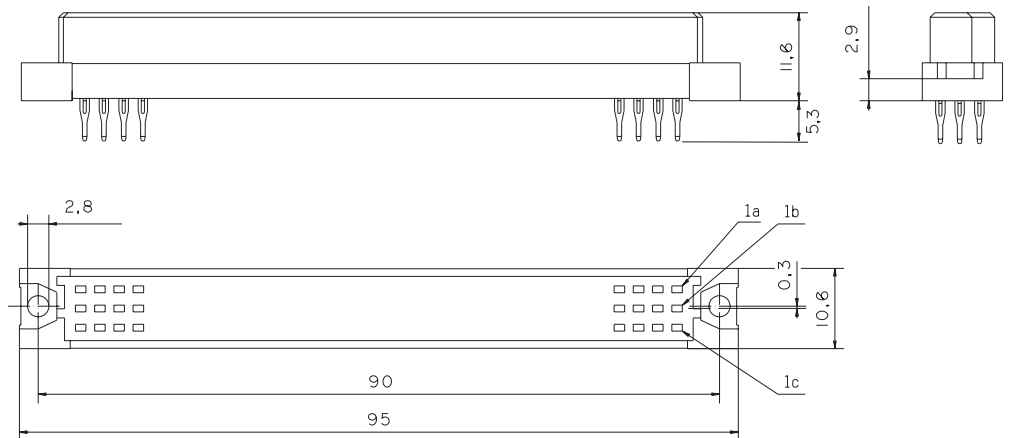

Type C/2

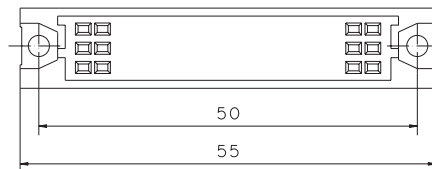

Type C/3

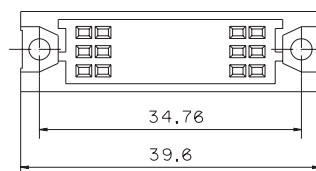

Connector Type	Number of Contacts	Arrangement of Contacts	Class 1 P/N	Class 2 P/N	Class 3 P/N	Notes
Type M Connector	78 + 2	a + b + c	350.081.900	350.081.900/2	350.081.900/6	
Male Right Angle Solder Pins	60 + 4	a + b + c	350.081.901	350.081.901/2	350.081.901/6	
	42 + 6	a + b + c	350.081.902	350.081.902/2	350.081.902/6	
	24 + 8	a + b + c	350.081.903	350.081.903/2	350.081.903/6	
Type M/2 Connector	30 + 2	a + b + c	350.081.910	350.081.910/2	350.081.910/6	
Male Right Angle Solder Pins						

### Type M

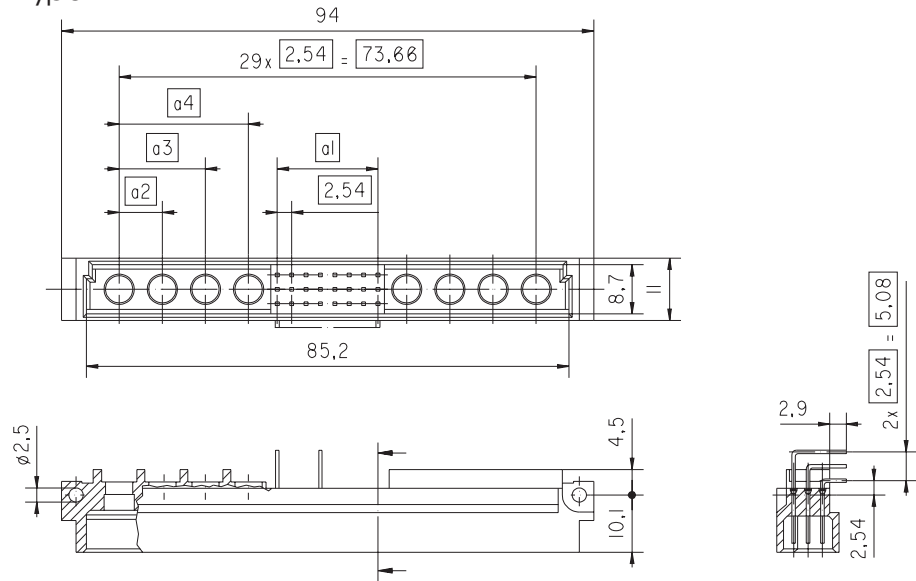

	a1	a2	a3	a4
78	$25 \times 2.54 = 63.50$	—	—	—
60	$19 \times 2.54 = 48.26$	$3 \times 2.54 = 7.62$	—	—
42	$13 \times 2.54 = 33.02$	$3 \times 2.54 = 7.62$	$6 \times 2.54 = 15.24$	—
24	$7 \times 2.54 = 17.78$	$3 \times 2.54 = 7.62$	$6 \times 2.54 = 15.24$	$9 \times 2.54 = 22.86$

### Type M/2

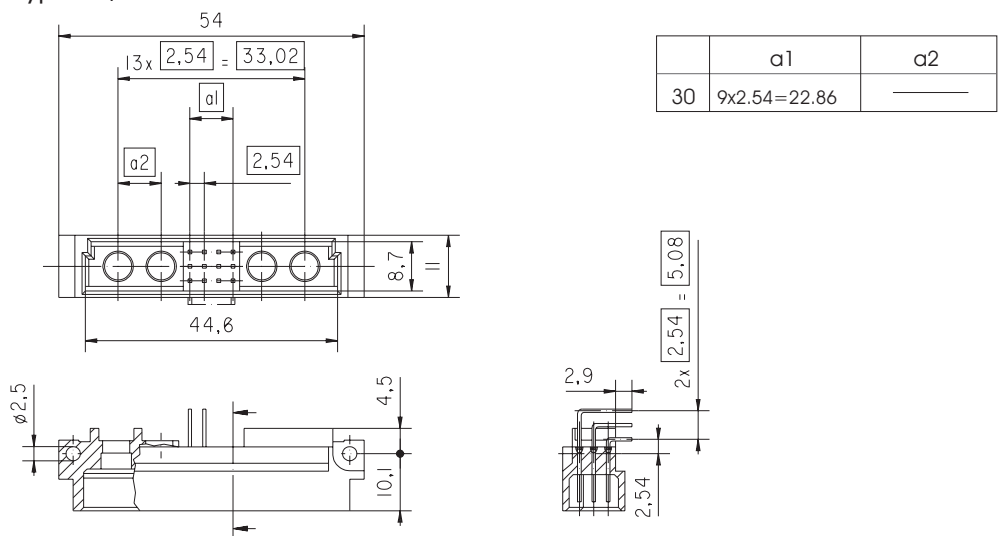

	a1	a2
30	$9 \times 2.54 = 22.86$	—

Connector Type	Number of Contacts	Arrangement of Contacts	Class 1 P/N	Class 2 P/N	Class 3 P/N	Notes
Type M	78 + 2	a + b + c	350.080.930	350.080.930/2	350.080.930/6	
Female	60 + 4	a + b + c	350.080.931	350.080.931/2	350.080.931/6	
Straight Solder Pins	42 + 6	a + b + c	350.080.932	350.080.932/2	350.080.932/6	
L = 2.9 mm	24 + 8	a + b + c	350.080.933	350.080.933/2	350.080.933/6	
Type M Connector	78 + 2	a + b + c	350.080.960			
Female	60 + 4	a + b + c	350.080.961			
Straight Solder Pins	42 + 6	a + b + c	350.080.962			
L = 4.5 mm	24 + 8	a + b + c	350.080.963			
Type M Connector	78 + 2	a + b + c	350.080.900			
Female	60 + 4	a + b + c	350.080.901			
Press-Fit Technique	42 + 6	a + b + c	350.080.902			
L = 5.3 mm	24 + 8	a + b + c	350.080.903			
Type M/2 Connector	30 + 2	a + b + c	350.080.940			
Female	12 + 4	a + b + c	350.080.941			
Straight Solder Pins						
L = 2.9 mm						
Type M/2 Connector	30 + 2	a + b + c	350.080.970			
Female	12 + 4	a + b + c	350.080.971			
Straight Solder Pins						
L = 4.5 mm						
Type M/2 Connector	30 + 2	a + b + c	350.080.910			
Female	12 + 4	a + b + c	350.080.911			
Press-Fit Technique						
L = 2.9 mm						

### Type M

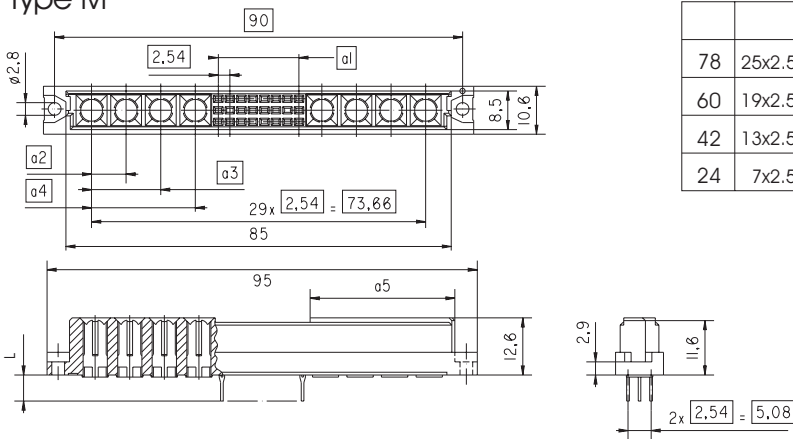

	a1	a2	a3	a4	a5
78	25x2.54=63.50	—	—	—	9.08
60	19x2.54=48.26	3x2.54=7.62	—	—	16.70
42	13x2.54=33.02	3x2.54=7.62	6x2.54=15.24	—	24.32
24	7x2.54=17.78	3x2.54=7.62	6x2.54=15.24	9x2.54=22.86	31.94

### Type M/2

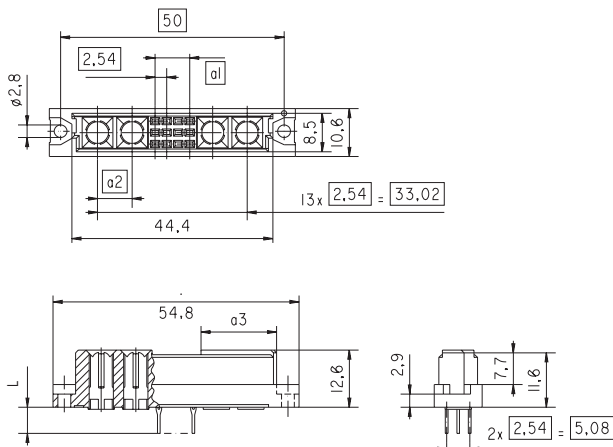

	a1	a2	a3
30	9x2.54=22.86	—	9.08
12	3x2.54=7.62	3x2.54=7.62	16.70

Connector Type	Number of Contacts	Arrangement of Contacts	Class 1 P/N	Class 2 P/N	Class 3 P/N	Notes
Type Q Connector Male	64	a + b	350.083.200	350.083.200/2	350.083.200/6	
Straight Solder Pins L = 2.9 mm	32	a + b, np	350.083.201	350.083.201/2	350.083.201/6	
	32	a	350.083.202	350.083.202/2	350.083.202/6	
	32	b	350.083.203	350.083.203/2	350.083.203/6	
	64	a + b	350.083.250	350.083.250/2	350.083.250/6	
Type Q Connector Male	64	a + b	350.083.250	350.083.250/2	350.083.250/6	
Type Q Connectors Male Straight Wrap Posts L = 13 mm	64	a + b	350.083.000	350.083.000/2	350.083.000/6	
	32	a + b, np	350.083.001	350.083.001/2	350.083.001/6	
	32	a	350.083.002	350.083.002/2	350.083.002/6	
	32	b	350.083.003	350.083.003/2	350.083.003/6	
Type Q Connector Male Press-Fit Technique	64	a + b	350.083.460			L = 5.3 mm
	64	a + b	350.083.530			L = 13.2 mm
	64	a + b	350.083.700			L = 17.8 mm
	64	a + b	350.083.600			L = 20.0 mm

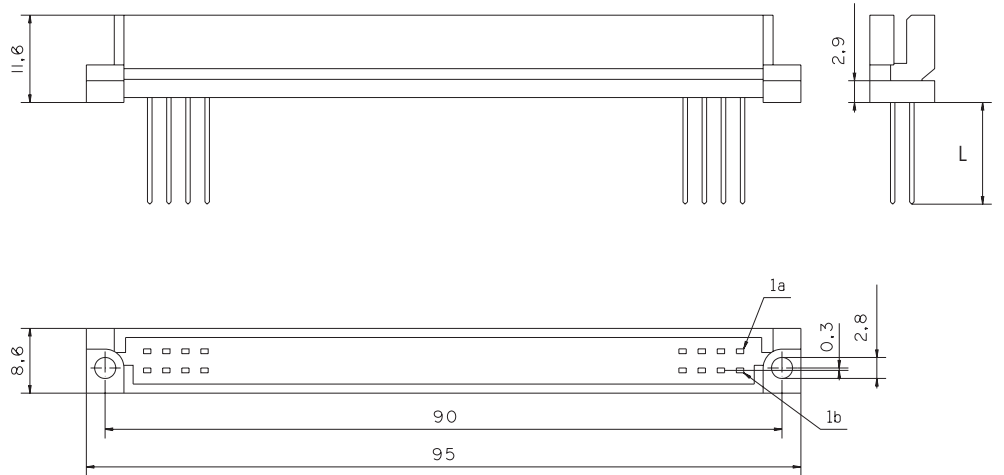

Connector Type	Number of Contacts	Arrangement of Contacts	Class 1 P/N	Class 2 P/N	Class 3 P/N	Notes
Type Q/2 Connector Male Straight Solder Pins L = 2.9 mm	32	a + b	350.083.220	350.083.220/2	350.083.220/6	
	16	a + b, np	350.083.221	350.083.221/2	350.083.221/6	
	16	a	350.083.222	350.083.222/2	350.083.222/6	
	16	b	350.083.223	350.083.223/2	350.083.223/6	
Type Q/2 Connector Male Straight Solder Pins L = 4.5 mm	32	a + b	350.083.270	350.083.270/2	350.083.270/6	
	16	a + b, np	350.083.271	350.083.271/2	350.083.271/6	
	16	a	350.083.272	350.083.272/2	350.083.272/6	
	16	b	350.083.273	350.083.273/2	350.083.273/6	
Type Q/2 Connector Male Straight Wrap Posts L = 13 mm	32	a + b	350.083.020	350.083.020/2	350.083.020/6	
	16	a + b, np	350.083.021	350.083.021/2	350.083.021/6	
	16	a	350.083.022	350.083.022/2	350.083.022/6	
	16	b	350.083.023	350.083.023/2	350.083.023/6	
Type Q/2 Connector Male Press-Fit Technique	32	a + b	350.083.480			L = 5.3 mm
	32	a + b	350.083.550			L = 13.2 mm
	32	a + b	350.083.720			L = 17.8 mm
	32	a + b	350.083.620			L = 20.0 mm

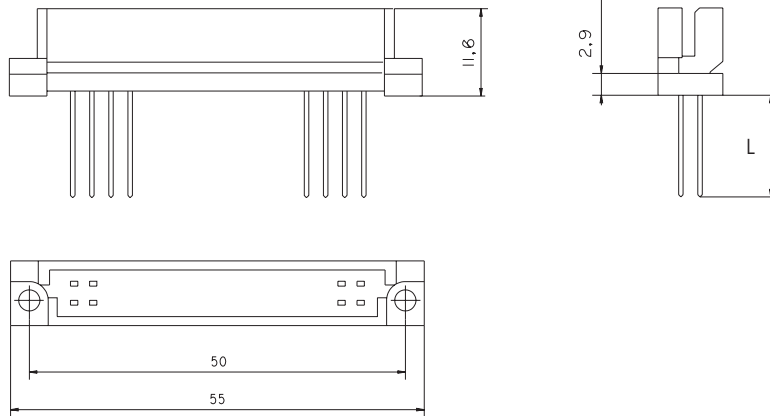

Connector Type	Number of Contacts	Arrangement of Contacts	Class 1 P/N	Class 2 P/N	Class 3 P/N	Notes
Type Q Connector Female Right Angle Solder Pins	64	a + b	350.082.200	350.082.200/2	350.082.200/6	
	32	a + b, np	350.082.201	350.082.201/2	350.082.201/6	
	32	a	350.082.202	350.082.202/2	350.082.202/6	
	32	b	350.082.203	350.082.203/2	350.082.203/6	
Type Q/2 Connector Female Right Angle Solder Pins	32	a + b	350.082.220	350.082.220/2	350.082.220/6	
	16	a + b, np	350.082.221	350.082.221/2	350.082.221/6	
	16	a	350.082.222	350.082.222/2	350.082.222/6	
	16	b	350.082.223	350.082.223/2	350.082.223/6	

Type Q

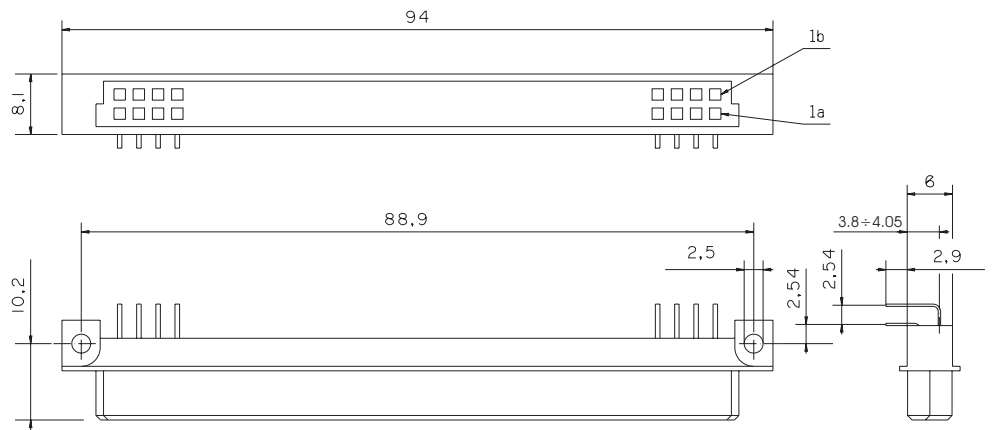

Type Q/2

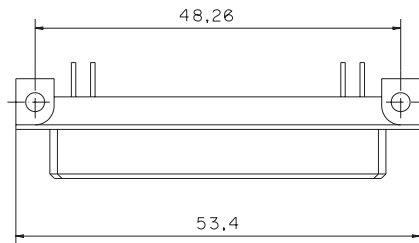



Connector Type	Number of Contacts	Arrangement of Contacts	Class 1 P/N	Class 2 P/N	Class 3 P/N	Notes
Type R Connector Male Straight Solder Pins L = 2.9 mm	96	a + b + c	350.083.210	350.083.210/2	350.083.210/6	(*)
	64	a + c	350.083.211	350.083.211/2	350.083.211/6	
	32	a + c, np	350.083.212	350.083.212/2	350.083.212/6	
	32	a	350.083.215	350.083.215/2	350.083.215/6	
	94 + 2c	a + b + c	350.083.310			
Type R Connector Male Straight Solder Pins L = 4.5 mm	96	a + b + c	350.083.260	350.083.260/2	350.083.260/6	(*)
	64	a + c	350.083.261	350.083.261/2	350.083.261/6	
	32	a + c, np	350.083.262	350.083.262/2	350.083.262/6	
	32	a	350.083.265	350.083.265/2	350.083.265/6	
	94 + 2c	a + b + c	350.083.360			
Type R Connector Male Straight Wrap Posts L = 13 mm	96	a + b + c	350.083.010	350.083.010/2	350.083.010/6	(*)
	64	a + c	350.083.011	350.083.011/2	350.083.011/6	
	32	a + c, np	350.083.012	350.083.012/2	350.083.012/6	
	94 + 2c	a + b + c	350.083.110			
Type R Connector Male Press-Fit Technique	96	a + b + c	350.083.760		L = 5.3 mm	
	94 + 2c	a + b + c	350.083.476		L = 5.3 mm (*)	
	96	a + b + c	350.083.540		L = 13.2 mm	
	94 + 2c	a + b + c	350.083.546		L = 13.2 mm (*)	
	96	a + b + c	350.083.710		L = 17.8 mm	
	94 + 2c	a + b + c	350.083.719		L = 17.8 mm (*)	
	96	a + b + c	350.083.610		L = 20.0 mm	
	94 + 2c	a + b + c	350.083.618		L = 20.0 mm (*)	
	64	a + c	350.083.766		L = 5.3 mm	
	64	a + c	350.083.541		L = 13.2 mm	
	64	a + c	350.083.711		L = 17.8 mm	
	64	a + c	350.083.611		L = 20.0 mm	

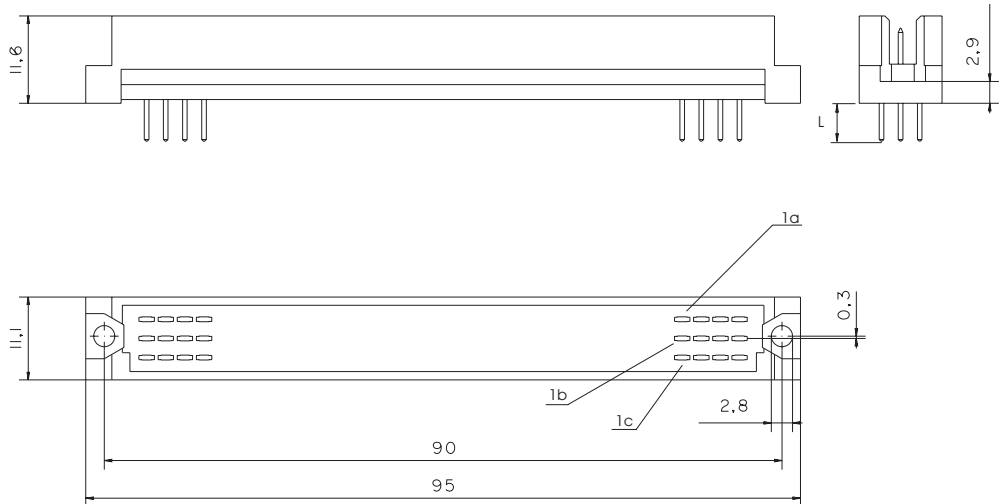

(\*) First mating contacts  
1a - 32a

Connector Type	Number of Contacts	Arrangement of Contacts	Class 1 P/N	Class 2 P/N	Class 3 P/N	Notes
Type R/2 Connector Male Straight Solder Pins L = 2.9 mm	48	a + b + c	350.083.230	350.083.230/2	350.083.230/6	
	32	a + c	350.083.231	350.083.231/2	350.083.231/6	
	16	a + c, np	350.083.232	350.083.232/2	350.083.232/6	
Type R/2 Connector Male Straight Solder Pins L = 4.5 mm	48	a + b + c	350.083.280			
	32	a + c	350.083.281			
	16	a + c, np	350.083.282			
Type R/2 Connector Male Straight Wrap Posts L = 13 mm	48	a + b + c	350.083.030	350.083.030/2	350.083.030/6	
	32	a + c	350.083.031	350.083.031/2	350.083.031/6	
	16	a + c, np	350.083.032	350.083.032/2	350.083.032/6	
Type R/2 Connector Male Press-Fit Technique	48	a + b + c	350.083.490			L = 5.3 mm
	48	a + b + c	350.083.560			L = 13.2 mm
	48	a + b + c	350.083.730			L = 17.8 mm
	48	a + b + c	350.083.630			L = 20.0 mm
	32	a + c	350.083.491			L = 5.3 mm
	32	a + c	350.083.561			L = 13.2 mm
	32	a + c	350.083.731			L = 17.8 mm
	32	a + c	350.083.631			L = 20.0 mm

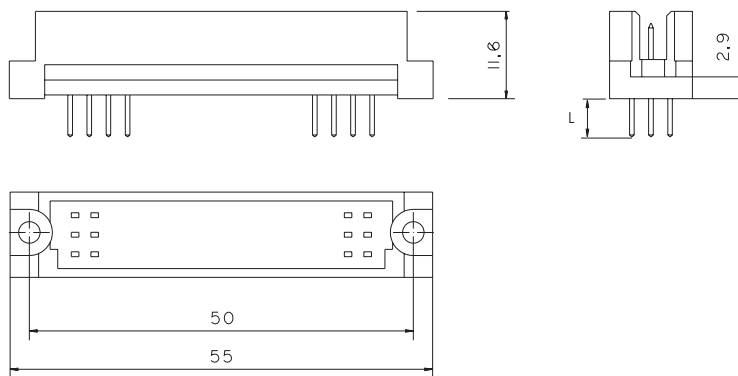

Connector Type	Number of Contacts	Arrangement of Contacts	Class 1 P/N	Class 2 P/N	Class 3 P/N	Notes
Type R Connector	96	a + b + c	350.082.210	350.082.210/2	350.082.210/6	
Female	64	a + c	350.082.211	350.082.211/2	350.082.211/6	
Right Angle Solder Pins	32	a + c, np	350.082.212	350.082.212/2	350.082.212/6	
	32	a	350.082.215	350.082.215/2	350.082.215/6	
Type R/2 Connector	48	a + b + c	350.082.230	350.082.230/2	350.082.230/6	
Female	32	a + c	350.082.231	350.082.231/2	350.082.231/6	
Right Angle Solder Pins	16	a + c, np	350.082.232	350.082.232/2	350.082.232/6	

Type R

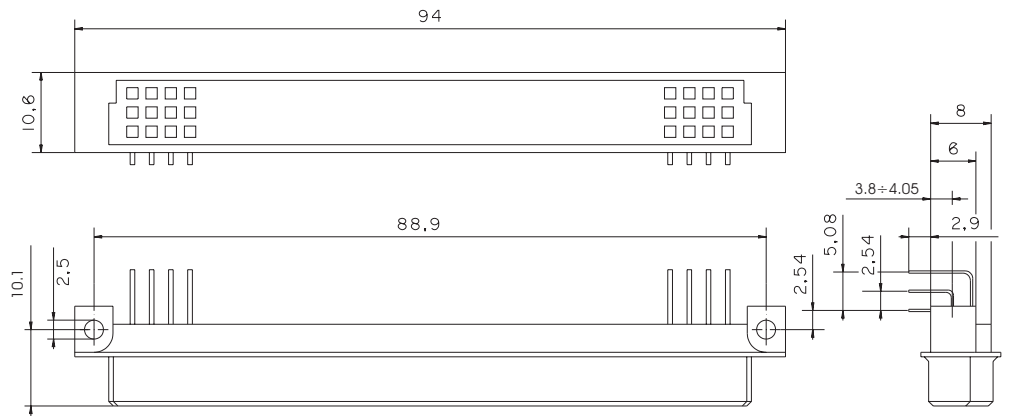

Type R/2

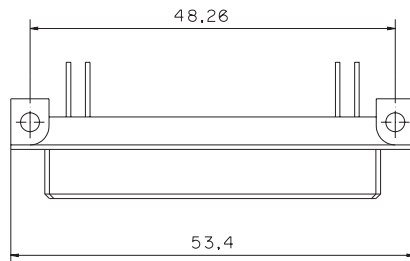

Connector Type	Number of Contacts	Arrangement of Contacts	Class 1 P/N	Class 2 P/N	Class 3 P/N	Notes
Type M Connector	78 + 2	a + b + c	350.083.900			
Reversed	60 + 4	a + b + c	350.083.901			
Male	42 + 6	a + b + c	350.083.902			
Press-Fit Technique L = 5.3 mm	24 + 8	a + b + c	350.083.903			

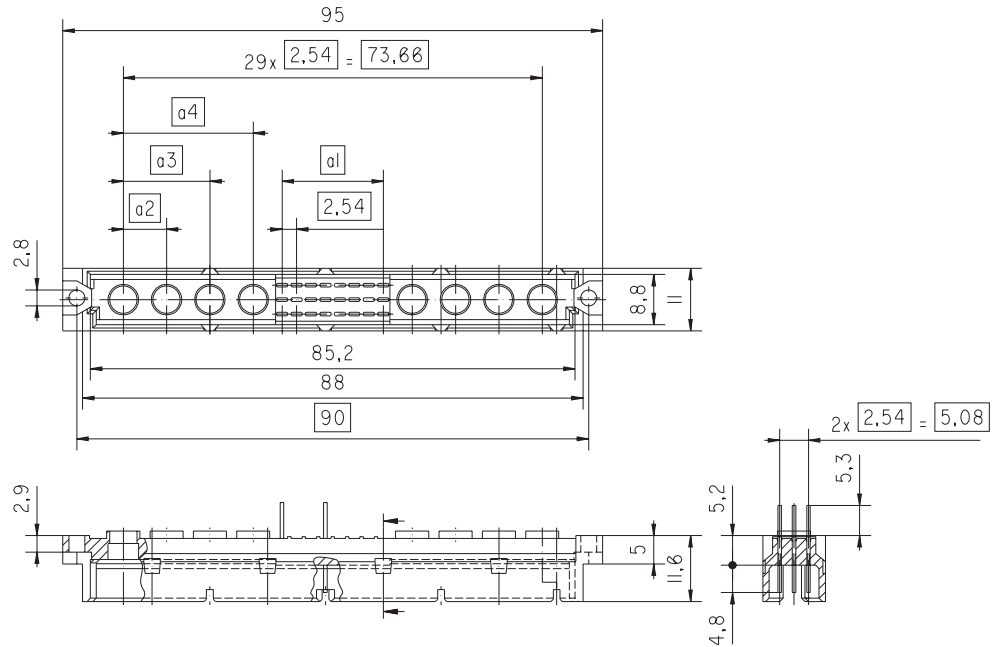

	a1	a2	a3	a4
78	25x2.54=63.50	—	—	—
60	19x2.54=48.26	3x2.54=7.62	—	—
42	13x2.54=33.02	3x2.54=7.62	6x2.54=15.24	—
24	7x2.54=17.78	3x2.54=7.62	6x2.54=15.24	9x2.54=22.86

Connector Type	Number of Contacts	Arrangement of Contacts	Class 1 P/N	Class 2 P/N	Class 3 P/N	Notes
Type M Connector	78 + 2	a + b + c	350.082.900			
Reversed	60 + 4	a + b + c	350.082.901			
Female	42 + 6	a + b + c	350.082.902			
Right Angle Solder Pins L = 2.9 mm	24 + 8	a + b + c	350.082.903			

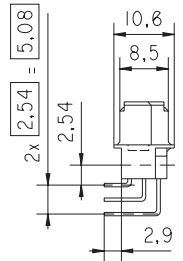
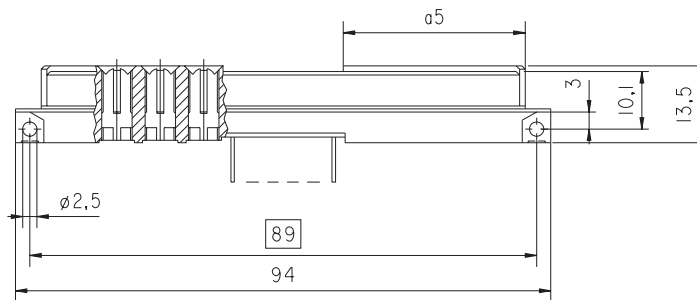
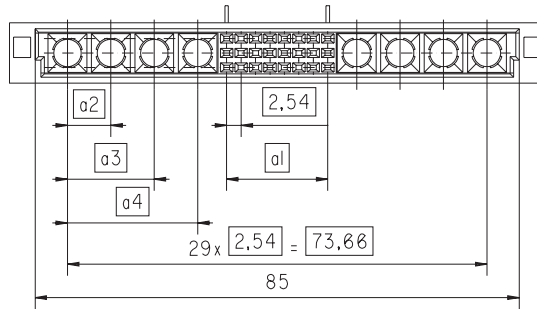

	a1	a2	a3	a4	a5
78	25x2.54=63.50	————	————	————	9.08
60	19x2.54=48.26	3x2.54=7.62	————	————	16.70
42	13x2.54=33.02	3x2.54=7.62	6x2.54=15.24	————	24.32
24	7x2.54=17.78	3x2.54=7.62	6x2.54=15.24	9x2.54=22.86	31.94

Contact Type	Termination	Working Current	Class 1 P/N	Notes
Straight Male Power Contact	Hand Solder	10 A	350.058.630	
		20 A	350.058.631	
		30 A	350.058.632	
		40 A	350.058.633	
	Crimp	10 A	350.058.670	
		20 A	350.058.671	
		30 A	350.058.672	
		40 A	350.058.673	
Straight Female Power Contact	Hand Solder	10 A	350.058.530	
		20 A	350.058.531	
		30 A	350.058.532	
		40 A	350.058.533	
	Crimp	10 A	350.058.570	
		20 A	350.058.571	
30 A	350.058.572			
40 A	350.058.573			
Right Angle Male Power Contact	For PCB with 4 pins	10 A	350.058.650	
Right Angle Female Power Contact	For PCB with 4 pins	10 A	350.058.550	

**MALE CONTACTS**
**Solder**

Working Current	A	Wire	AWG
10 A	1.7	1.3 mm <sup>2</sup>	16
20 A	2.8	3.3 mm <sup>2</sup>	12
30 A	3.5	2.6 mm <sup>2</sup>	10
40 A	4.8	8.3 mm <sup>2</sup>	8

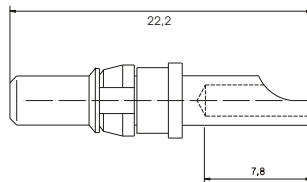
**Crimp**

Working Current	A	Wire	AWG
10 A	1.7	1.3 mm <sup>2</sup>	16
20 A	2.8	3.3 mm <sup>2</sup>	12
30 A	3.5	2.6 mm <sup>2</sup>	10
40 A	4.8	8.3 mm <sup>2</sup>	8

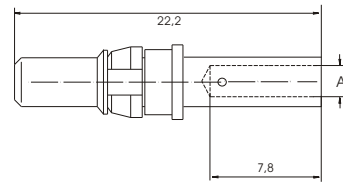
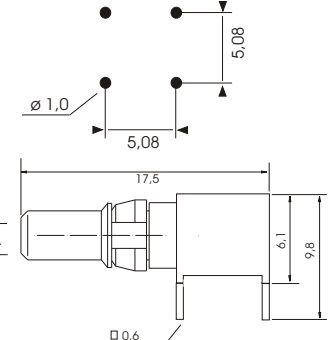
**Right Angle Working Current 10 A  
PCB Cutout Dimensions**

**FEMALE CONTACTS**
**Solder**

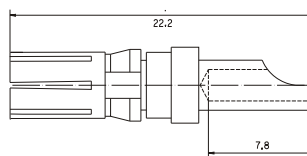
Working Current	A	Wire	AWG
10 A	1.7	1.3 mm <sup>2</sup>	16
20 A	2.8	3.3 mm <sup>2</sup>	12
30 A	3.5	2.6 mm <sup>2</sup>	10
40 A	4.8	8.3 mm <sup>2</sup>	8

**Crimp**

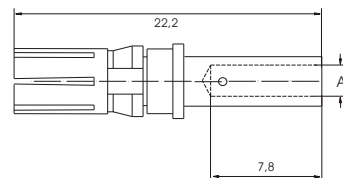
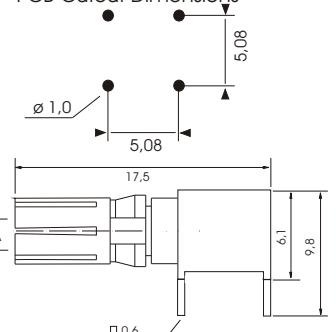
Working Current	A	Wire	AWG
10 A	1.7	1.3 mm <sup>2</sup>	16
20 A	2.8	3.3 mm <sup>2</sup>	12
30 A	3.5	2.6 mm <sup>2</sup>	10
40 A	4.8	8.3 mm <sup>2</sup>	8



**Right Angle Working Current 10 A  
PCB Cutout Dimensions**

**Features**

**Male Contact:**  
**Female Contact:**  
**Retention Spring:**  
**Finishes:**  
**Contact Resistance:**  
**Temperature Range:**

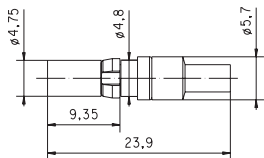
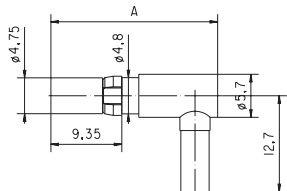
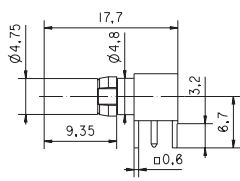
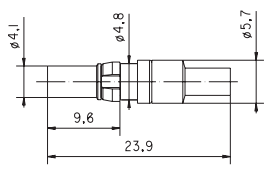
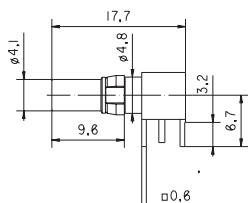
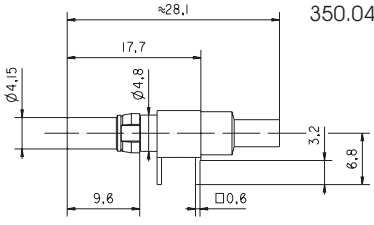
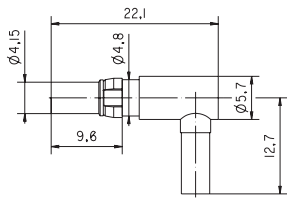
**Brass**  
**CuBe (spring side)**  
**CuBe**  
**Au over Ni**  
**5 mohms max**  
**- 55°C ... +125°C**

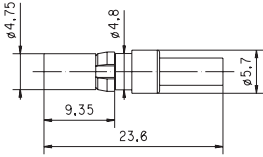
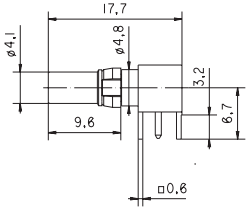
For other versions, please contact us.

		Part Number	Cable	Ø outer	A
Male connector insert for DIN 41612 M Type female connector		350.044.705	RG174/U (50Ω) RG188A/U (50Ω) RG316/U (50Ω)	2.79 ± 0.127 2.79 max 2.49 ± 0.1	
Coupling type: E					
Cable attachment: - inner contact: solder - outer contact: crimp					
Male connector insert for DIN 41612 M Type female connector		350.044.750	RG174/U (50Ω) RG188A/U (50Ω) RG316/U (50Ω)	2.79 ± 0.127 2.79 max 2.49 ± 0.1	18.6
Coupling type: E		350.044.751	RG174/U (50Ω) RG188A/U (50Ω)	2.79 ± 0.127 2.79 max	22.1
Cable attachment: - inner contact: solder - outer contact: crimp		350.044.752	RG316/U (50Ω) RG174/U (50Ω) RG188A/U (50Ω) RG316/U (50Ω)	2.49 ± 0.1 2.79 ± 0.127 2.79 max 2.49 ± 0.1	24.0
Male connector insert for DIN 41612 M Type female connector		350.044.731			
Coupling type: E					
Termination: solder					
PCB cutout dimensions: Type 5					
Female connector insert for DIN 41612 M Type male connector		350.044.800	RG174/U (50Ω) RG188A/U (50Ω) RG316/U (50Ω)	2.79 ± 0.127 2.79 max 2.49 ± 0.1	
Coupling type: E					
Cable attachment: - inner contact: solder - outer contact: crimp					
Female connector insert for DIN 41612 M Type male connector		350.044.831			
Coupling type: E					
Termination: solder					
PCB cutout dimensions: Type 5					
Female connector insert for DIN 41612 M Type male connector		350.044.836	RG174/U (50Ω) RG188A/U (50Ω) RG316/U (50Ω)	2.79 ± 0.127 2.79 max 2.49 ± 0.1	
Coupling type: E					
Cable and PCB attachment: - inner contact: solder - outer contact: crimp - PCB termination: solder					
PCB cutout dimensions: Type 16					
Female connector insert for DIN 41612 M Type male connector		350.044.850	RG174/U (50Ω) RG188A/U (50Ω) RG316/U (50Ω)	2.79 ± 0.127 2.79 max 2.49 ± 0.1	18.6
Coupling type: E		350.044.851	RG174/U (50Ω) RG188A/U (50Ω)	2.79 ± 0.127 2.79 max	22.1
Cable attachment: - inner contact: solder - outer contact: crimp - PCB termination: solder		350.044.852	RG316/U (50Ω) RG174/U (50Ω) RG188A/U (50Ω) RG316/U (50Ω)	2.49 ± 0.1 2.79 ± 0.127 2.79 max 2.49 ± 0.1	24.0

		Part Number	Cable	Ø outer
<p>Male connector insert for DIN 41612 M Type female connector</p> <p>Coupling type: E Cable attachment: - inner contact: solder - outer contact: crimp</p>		350.064.700	RG179B/U (75Ω) RG187A/U (75Ω)	2.54 ± 0.127 2.79 max
<p>Female connector insert for DIN 41612 M Type male connector</p> <p>Coupling type: E Termination: solder PCB cutout dimensions: Type 5</p>		350.064.831		



Right Angle Terminations

Straight Terminations

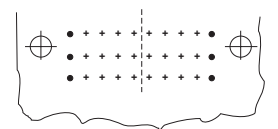
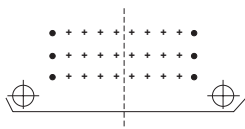
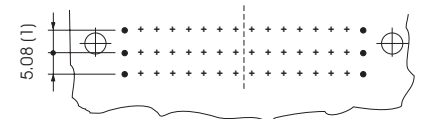
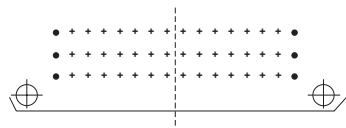
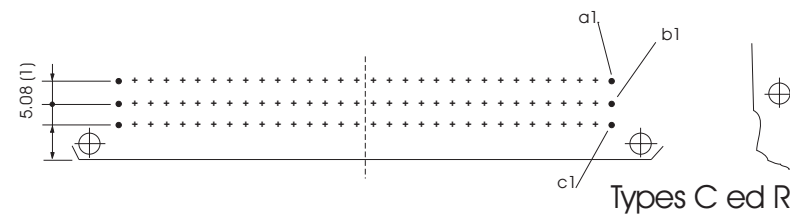
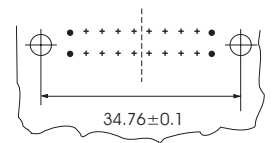
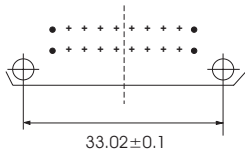
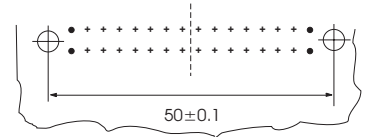
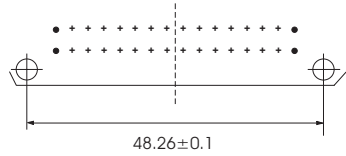
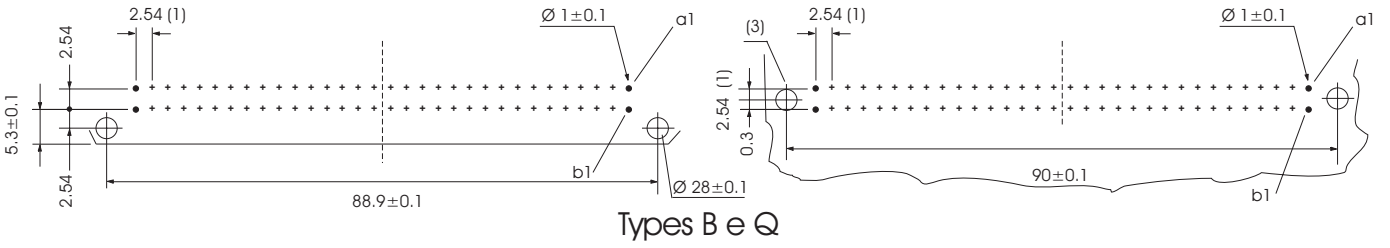

(1) Max Total Pitch Tolerance  $\pm 0.05$   
 (2) For Press-Fit see page 3

(3) Securing with 2 Hollow Rivets 2.5 x 0.3 x ...  
 DIN 7340, or with 2 Screws M 2.5 ... for  
 DIN 84 and 2 Nuts M 2.5 for DIN 934

Panel Cutout Dimensions for Straight Terminations

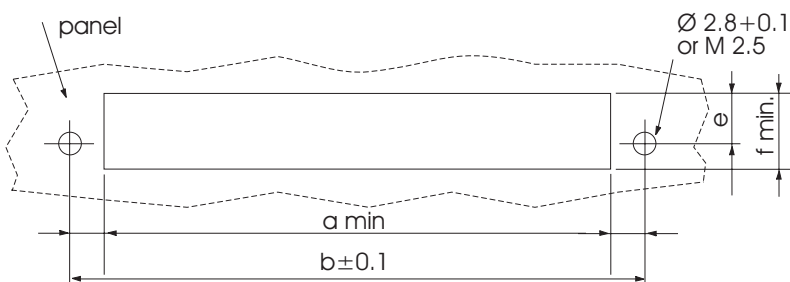

Type	a	b	e	f
B Q	85	90	5.1	8.3
B/2 Q/2	45	50	5.1	8.3
B/3 Q/3	30	34.76	5.1	8.3
C R	85	90	5.1	10.8
C/2 R/2	45	50	5.1	10.8
C/3 R/3	30	34.76	5.1	10.8

Insertion tool for Female Connectors  
Type C Press-Fit  
P/N: 430.835.000/1

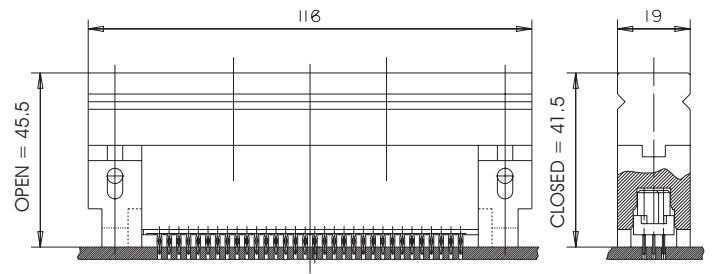

Insertion tool for Male Connectors  
Types R and M Reversed Press-Fit  
P/N: 430.836.000/1

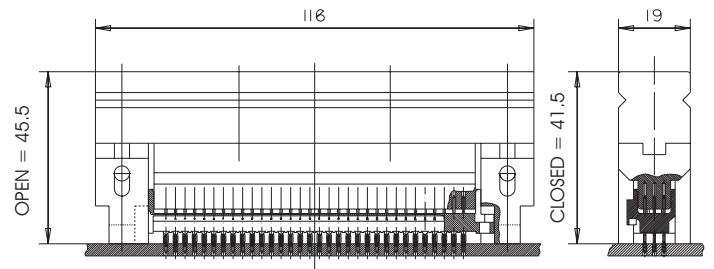

Insertion tool for Female Connectors  
Type M Press-Fit  
P/N: 430.833.000/1

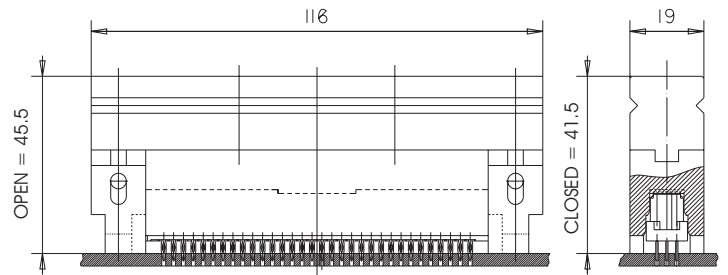

Insertion tool for Female Connectors  
Types C/2 and M/2 Press-Fit  
P/N: 430.834.000/1

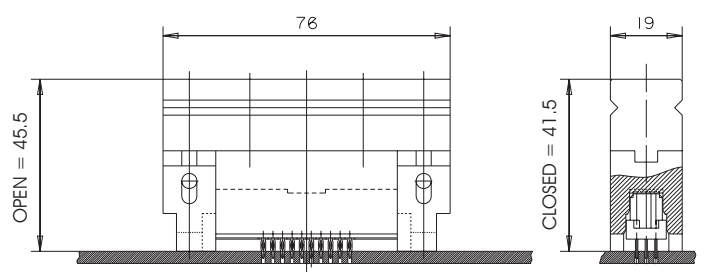

Insertion tool for Female Connectors  
Type C/3 Press-Fit  
P/N: 430.837.000/1

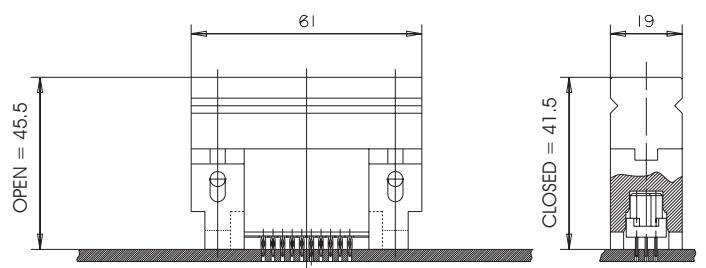

Part Number	Page	Part Number	Page	Part Number	Page	Part Number	Page
350.044.705	22	350.080.311	09	350.082.215	18	350.083.491	17
350.044.731	22	350.080.312	09	350.082.220	15	350.083.530	13
350.044.750	22	350.080.325	09	350.082.221	15	350.083.540	16
350.044.751	22	350.080.326	09	350.082.222	15	350.083.541	16
350.044.752	22	350.080.335	09	350.082.223	15	350.083.546	16
350.044.800	22	350.080.336	09	350.082.230	18	350.083.550	14
350.044.831	22	350.080.600	10	350.082.231	18	350.083.560	17
350.044.836	22	350.080.601	10	350.082.232	18	350.083.561	17
350.044.850	22	350.080.602	10	350.082.900	20	350.083.600	13
350.044.851	22	350.080.610	10	350.082.901	20	350.083.610	16
350.044.852	22	350.080.611	10	350.082.902	20	350.083.611	16
350.058.530	21	350.080.616	10	350.082.903	20	350.083.618	16
350.058.531	21	350.080.617	10	350.083.000	13	350.083.620	14
350.058.532	21	350.080.900	12	350.083.001	13	350.083.630	17
350.058.533	21	350.080.901	12	350.083.002	13	350.083.631	17
350.058.550	21	350.080.902	12	350.083.003	13	350.083.700	13
350.058.570	21	350.080.903	12	350.083.010	16	350.083.710	16
350.058.571	21	350.080.910	12	350.083.011	16	350.083.711	16
350.058.572	21	350.080.911	12	350.083.012	16	350.083.719	16
350.058.573	21	350.080.930	12	350.083.020	14	350.083.720	14
350.058.630	21	350.080.931	12	350.083.021	14	350.083.730	17
350.058.631	21	350.080.932	12	350.083.022	14	350.083.731	17
350.058.632	21	350.080.933	12	350.083.023	14	350.083.760	16
350.058.633	21	350.080.940	12	350.083.030	17	350.083.766	16
350.058.650	21	350.080.941	12	350.083.031	17	350.083.900	19
350.058.670	21	350.080.960	12	350.083.032	17	350.083.901	19
350.058.671	21	350.080.961	12	350.083.110	16	350.083.902	19
350.058.672	21	350.080.962	12	350.083.200	13	350.083.903	19
350.058.673	21	350.080.963	12	350.083.201	13		
350.064.700	23	350.080.970	12	350.083.202	13		
350.064.831	23	350.080.971	12	350.083.203	13		
350.080.000	06	350.081.200	05	350.083.210	16		
350.080.002	06	350.081.201	05	350.083.211	16		
350.080.003	06	350.081.202	05	350.083.212	16		
350.080.010	08	350.081.203	05	350.083.215	16		
350.080.011	08	350.081.210	07	350.083.220	14		
350.080.012	08	350.081.211	07	350.083.221	14		
350.080.030	09	350.081.212	07	350.083.222	14		
350.080.031	09	350.081.215	07	350.083.223	14		
350.080.032	09	350.081.220	05	350.083.230	17		
350.080.045	09	350.081.221	05	350.083.231	17		
350.080.046	09	350.081.230	07	350.083.232	17		
350.080.240	06	350.081.231	07	350.083.250	13		
350.080.242	06	350.081.232	07	350.083.260	16		
350.080.243	06	350.081.245	07	350.083.261	16		
350.080.250	08	350.081.246	07	350.083.262	16		
350.080.251	08	350.081.300	05	350.083.265	16		
350.080.252	08	350.081.311	07	350.083.270	14		
350.080.255	08	350.081.900	11	350.083.271	14		
350.080.270	09	350.081.901	11	350.083.272	14		
350.080.271	09	350.081.902	11	350.083.273	14		
350.080.272	09	350.081.903	11	350.083.280	17		
350.080.280	06	350.081.910	11	350.083.281	17		
350.080.282	06	350.082.200	15	350.083.282	17		
350.080.283	06	350.082.201	15	350.083.310	16		
350.080.290	08	350.082.202	15	350.083.360	16		
350.080.291	08	350.082.203	15	350.083.460	13		
350.080.292	08	350.082.210	18	350.083.476	16		
350.080.295	08	350.082.211	18	350.083.480	14		
350.080.310	09	350.082.212	18	350.083.490	17		

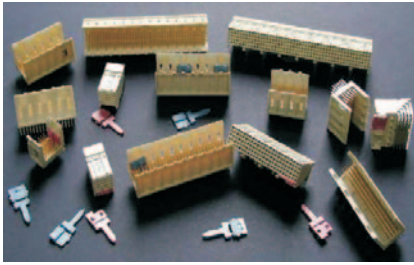
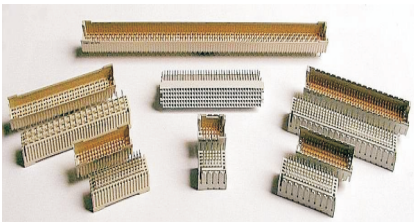
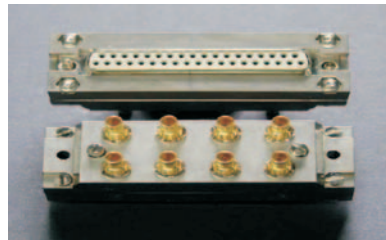
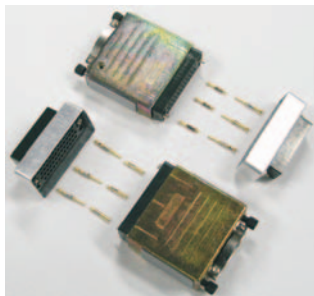
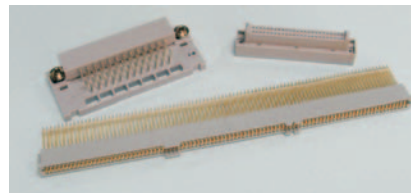
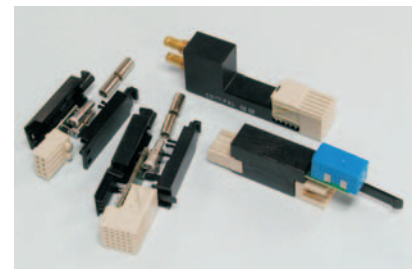
**COM-MET 2****POWER AND FILTERED D-SUB****TEST AND LINK****COM-MET 2,5****ADAPTER BOX****DIN 41612****RECTANGULAR CONNECTORS****CUSTOM CONNECTORS****ADAPTERS****FLEXIBLE JUMPERS****CRIMP TOOLS****EXTRACTION TOOLS**

Per informazioni più complete contattare la Società :  
*For further information please contact the factory :*

**Compel Electronics spa**

Via Guido Rossa 18

20040 Cornate d'Adda (MI) ITALY

Tel. +39 039 61001 Fax: +39 039 6926079

e-mail [sales@compel.it](mailto:sales@compel.it)

web site: [www.compel.it](http://www.compel.it)

