

4

3

2

1

THIS DRAWING IS UNPUBLISHED. RELEASED FOR PUBLICATION
 © COPYRIGHT BY TYCO ELECTRONICS CORPORATION. ALL RIGHTS RESERVED.

| LOC | DIST | REVISIONS | | | |
|-----|------|--|---------|-----|------|
| P | LTR | DESCRIPTION | DATE | DWN | APVD |
| | | REVISD (ECR-08-017825) ADD TRAY PACKAGE | 15JUL08 | AW | WK |
| | | REVISD (ECR-08-023728) CHANGE PACKAGE | 18SEP08 | BH | WK |

D

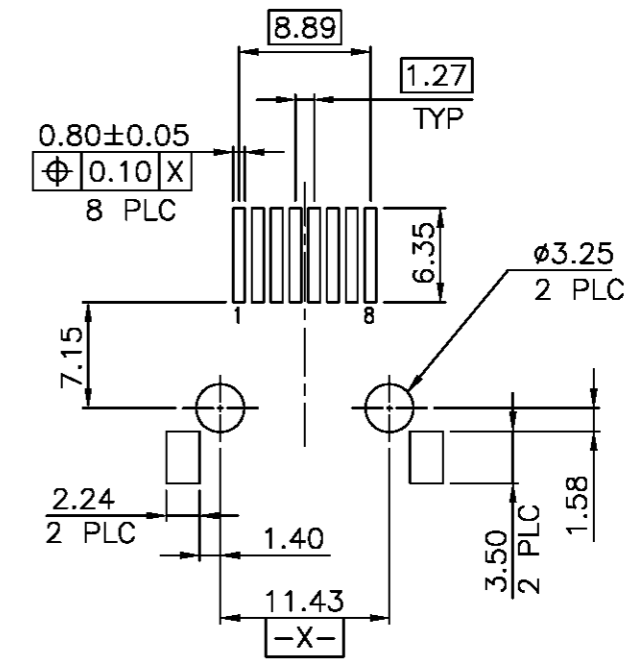
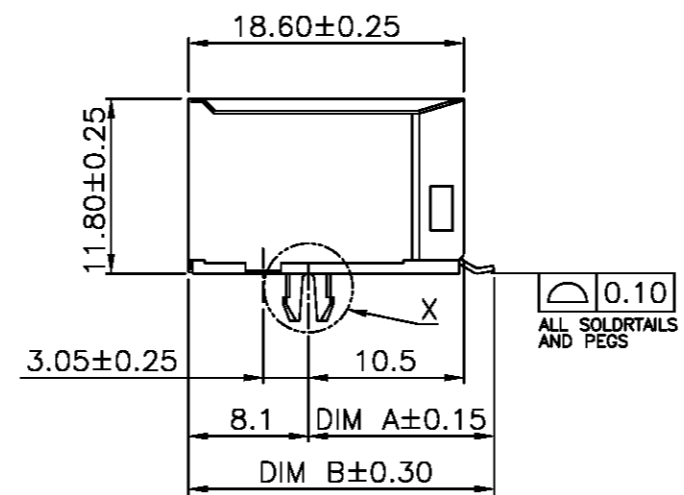
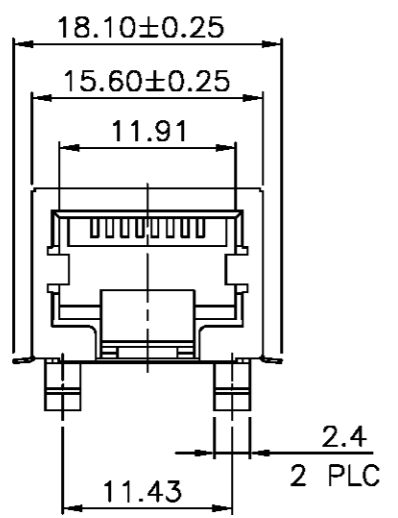
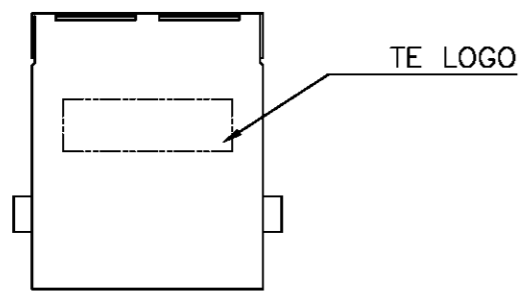

RECOMMENDED PCB LAYOUT (THICKNESS: 1.6mm)
 DIMENSION TOLERANCE: 1 PLC: ±0.1 2PLC: ±0.05)

C

B

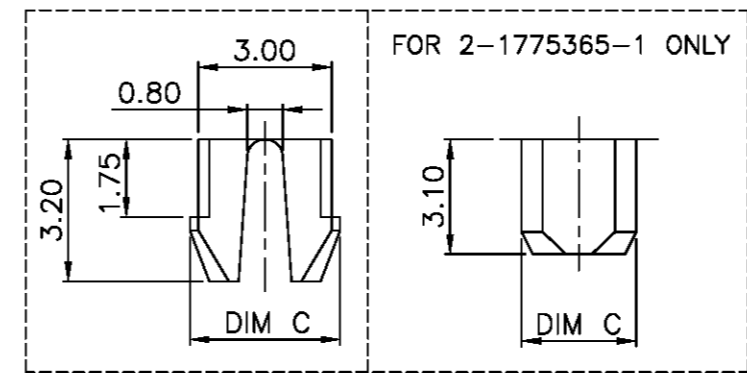
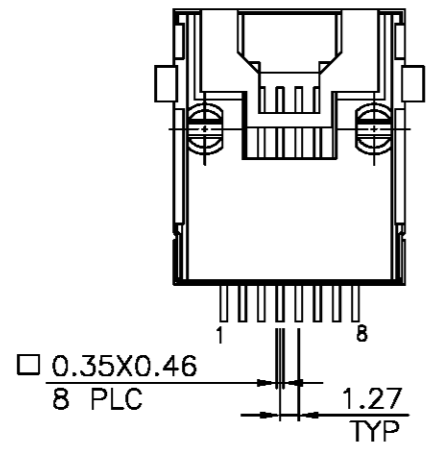

DETAIL X

| TRAY | 3.10 | 20.70 | 12.60 | 0.152µm [6µ"] | 2-1775365-1 |
|----------------|-----------|----------------|-----------|---------------------|-------------|
| REEL | 3.38 | 20.70 | 12.60 | 1.27µm [50µ"] | 1-1775365-4 |
| | | | | 0.762µm [30µ"] | 1-1775365-3 |
| | | 20.85 | 12.75 | 0.381µm [15µ"] | 1-1775365-2 |
| | | | | 0.152µm [6µ"] | 1-1775365-1 |
| | | 1.27µm [50µ"] | 1775365-4 | | |
| | | 0.762µm [30µ"] | 1775365-3 | | |
| 0.381µm [15µ"] | 1775365-2 | | | | |
| 0.152µm [6µ"] | 1775365-1 | | | | |
| PACKAGE | DIM C | DIM B | DIM A | MIN. GOLD THICKNESS | PART NUMBER |

NOTE:

- MATERIAL:
HOUSING: PA46 WITH 30% GF, UL 94V-0, BLACK COLOR.
CONTACTS: PHOSPHOR BRONZE.
SHIELD: BRASS.
- FINISH:
CONTACTS: (SEE TABLE) GOLD PLATED ON CONTACT AREA, GOLD FLASH ON SOLDER TAIL, WITH ENTIRE CONTACT UNDERPLATED 1.27µm [50µ"] MIN. NICKEL.
SHIELD: 0.51µm [20µ"] MIN. NICKEL PLATED.
- REFLOW SOLDER CAPABLE TO 260°C PER TE TEST SPEC. 109-201, CONDITION B.

| | | | | | | | | | | | | | | | | |
|--|--------|--|--|-------------------------|--------|-------|--------|-------|--------|-------|-----|--------|-----|---------------------------|------------|--|
| THIS DRAWING IS A CONTROLLED DOCUMENT. | | DWN B. HSING 18SEP2008 | Tyco Electronics Tyco Electronics Corporation Taipei, Taiwan | | | | | | | | | | | | | |
| DIMENSIONS: MM | | CHK S. CHIEN 18SEP2008 | NAME | | | | | | | | | | | | | |
| TOLERANCES UNLESS OTHERWISE SPECIFIED: | | APVD W. KODAMA 18SEP2008 | MODULAR JACK, RJ45 SHIELD, SMT TYPE | | | | | | | | | | | | | |
| <table border="1"> <tr><td>0 PLC</td><td>± 0.50</td></tr> <tr><td>1 PLC</td><td>± 0.38</td></tr> <tr><td>2 PLC</td><td>± 0.25</td></tr> <tr><td>3 PLC</td><td>± 0.10</td></tr> <tr><td>4 PLC</td><td>± -</td></tr> <tr><td>ANGLES</td><td>± -</td></tr> </table> | | 0 PLC | ± 0.50 | 1 PLC | ± 0.38 | 2 PLC | ± 0.25 | 3 PLC | ± 0.10 | 4 PLC | ± - | ANGLES | ± - | PRODUCT SPEC 108-57535 | SIZE A3 | |
| 0 PLC | ± 0.50 | | | | | | | | | | | | | | | |
| 1 PLC | ± 0.38 | | | | | | | | | | | | | | | |
| 2 PLC | ± 0.25 | | | | | | | | | | | | | | | |
| 3 PLC | ± 0.10 | | | | | | | | | | | | | | | |
| 4 PLC | ± - | | | | | | | | | | | | | | | |
| ANGLES | ± - | | | | | | | | | | | | | | | |
| MATERIAL SEE NOTE | | QUALIFICATION TEST REPORT 501-57718 | CAGE CODE 00779 | DRAWING NO C-1775365 | | | | | | | | | | | | |
| FINISH SEE NOTE | | WEIGHT 4.3 GRAMS | RESTRICTED TO | | | | | | | | | | | | | |
| CUSTOMER DRAWING | | SCALE | SHEET 1 of 3 | REV E1 | | | | | | | | | | | | |

4

3

2

1

THIS DRAWING IS UNPUBLISHED. RELEASED FOR PUBLICATION
 © COPYRIGHT BY TYCO ELECTRONICS CORPORATION. ALL RIGHTS RESERVED.

| | | | | | |
|-----|------|-----------|-----|--------------|------|
| LOC | DIST | REVISIONS | | | |
| DW | | P | LTR | DESCRIPTION | DATE |
| | | | | SEE SHEET 1. | |
| | | | | | |

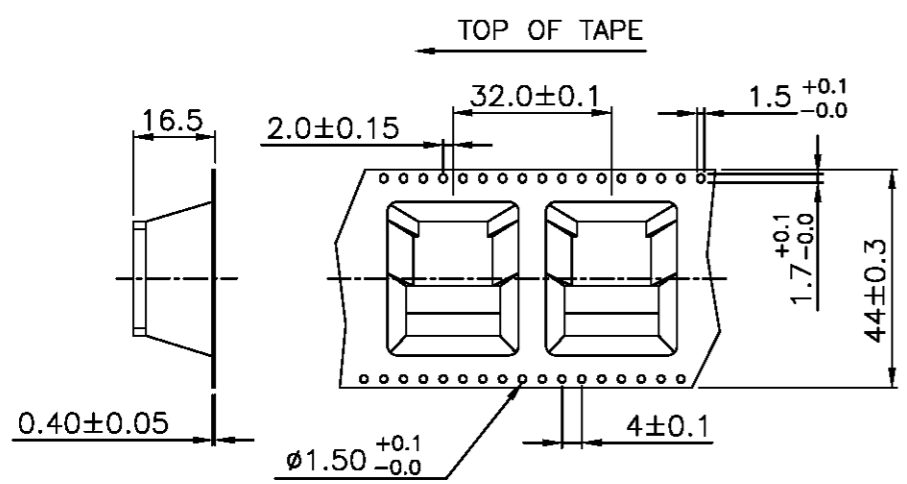
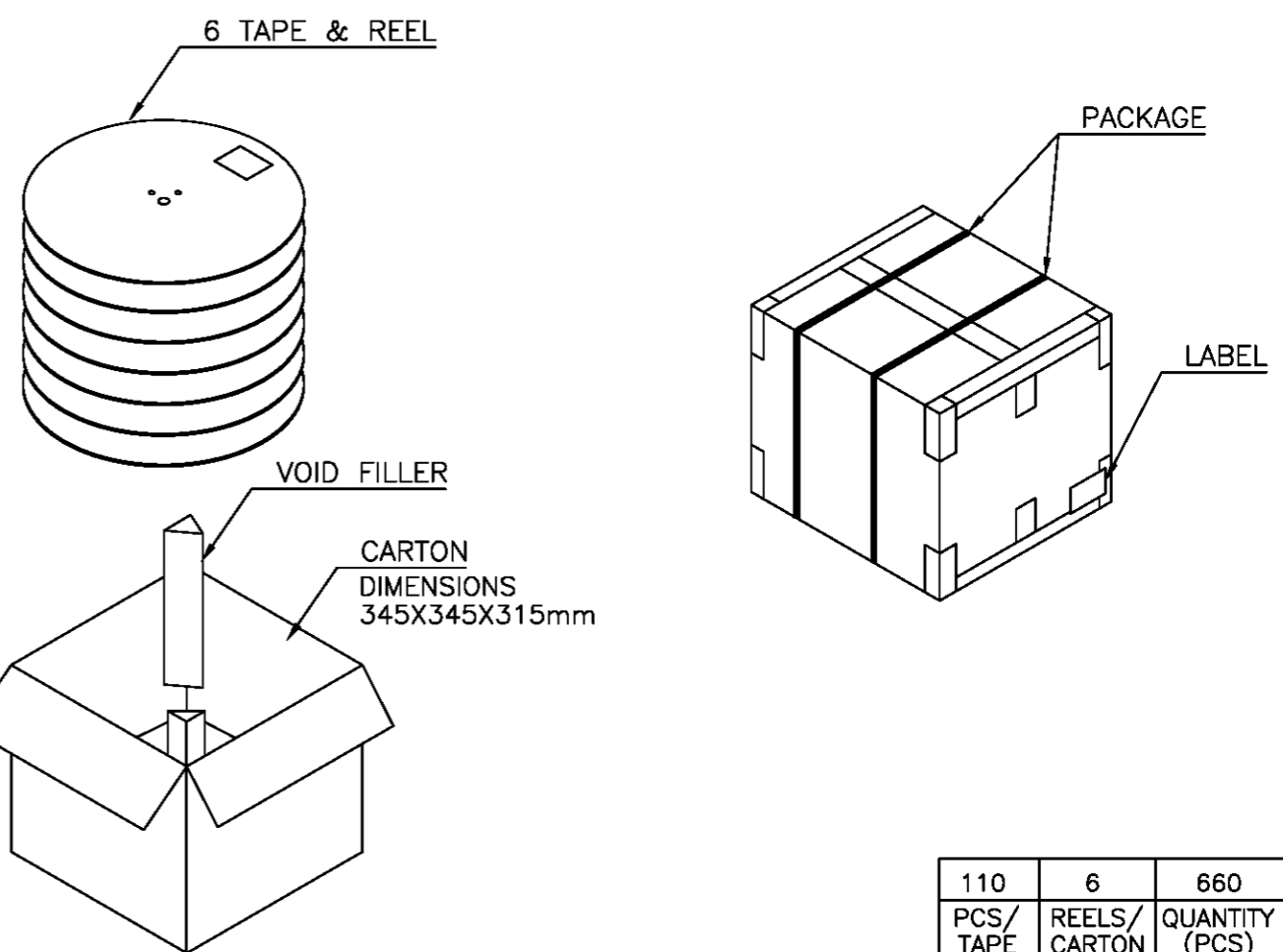
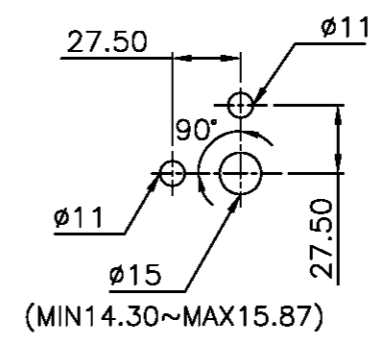
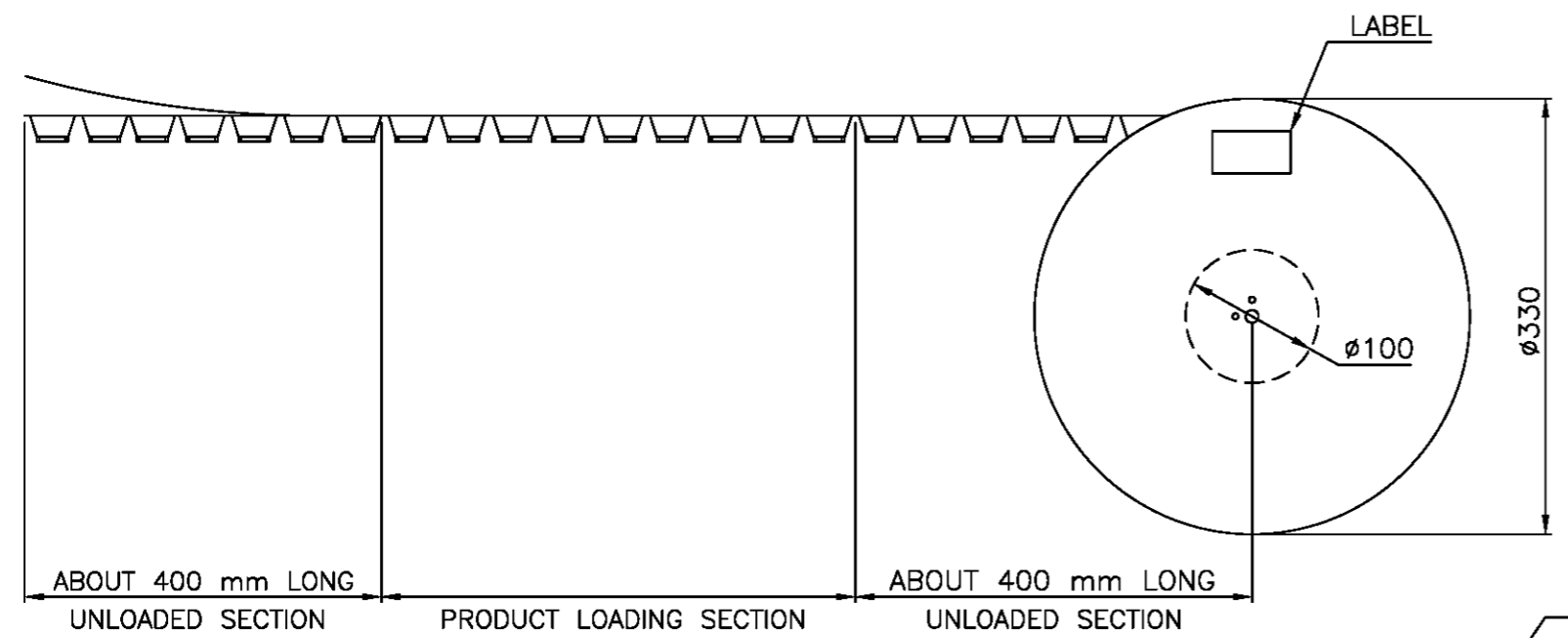

| | | | | |
|----------|--------------|----------------|----------|----------|
| 110 | 6 | 660 | 3 | 4.5 |
| PCS/TAPE | REELS/CARTON | QUANTITY (PCS) | G/W (Kg) | N/W (Kg) |

| | | | | | |
|--|--|------------------|--|-----------|------------|
| THIS DRAWING IS A CONTROLLED DOCUMENT. | | DWN | Tyco Electronics Tyco Electronics Corporation Taipei, Taiwan | | |
| DIMENSIONS: MM | | CHK | NAME | | |
| TOLERANCES UNLESS OTHERWISE SPECIFIED: | | APVD | MODULAR JACK, RJ45 SHIELD, SMT TYPE | | |
| 0 PLC ± - | | PRODUCT SPEC | SIZE | CAGE CODE | DRAWING NO |
| 1 PLC ± - | | APPLICATION SPEC | A3 | 00779 | C=1775365 |
| 2 PLC ± - | | | RESTRICTED TO | | |
| 3 PLC ± - | | WEIGHT | - | | |
| 4 PLC ± - | | CUSTOMER DRAWING | SCALE | SHEET | REV |
| ANGLES ± - | | | - | 2 of 3 | E1 |
| FINISH | | | | | |

4

3

2

1

THIS DRAWING IS UNPUBLISHED. RELEASED FOR PUBLICATION
 © COPYRIGHT BY TYCO ELECTRONICS CORPORATION. ALL RIGHTS RESERVED.

| LOC | DIST | REVISIONS | | | | |
|-----|------|--------------|------|-----|------|--|
| P | LTR | DESCRIPTION | DATE | DWN | APVD | |
| DW | / | SEE SHEET 1. | | | | |

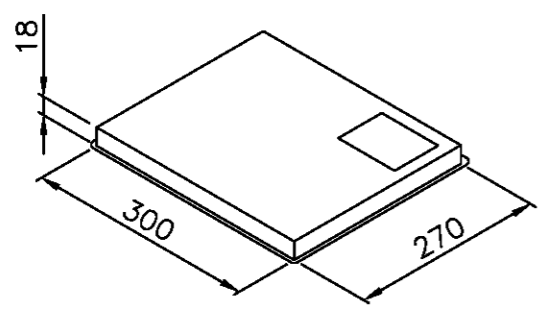
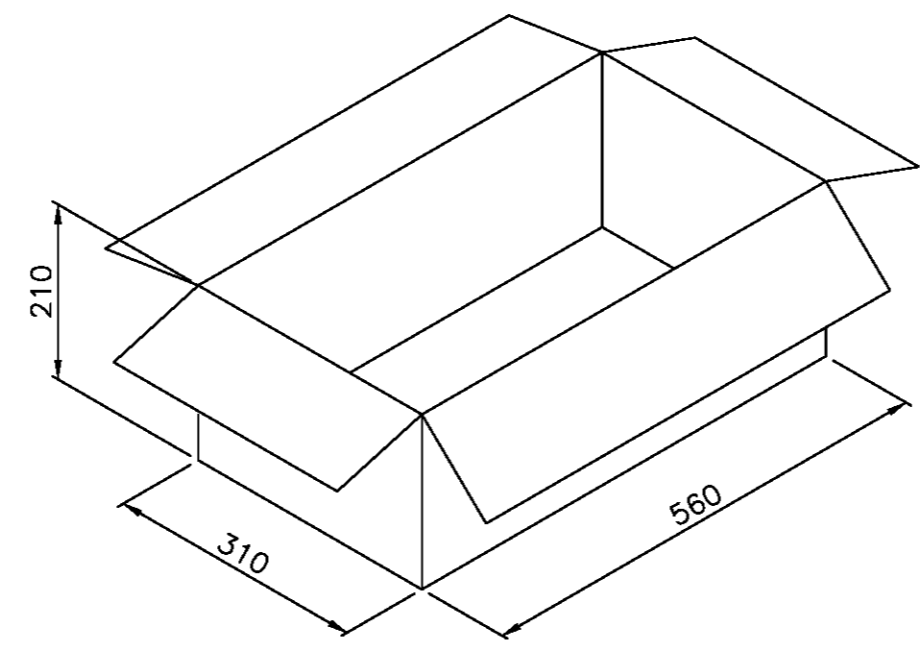
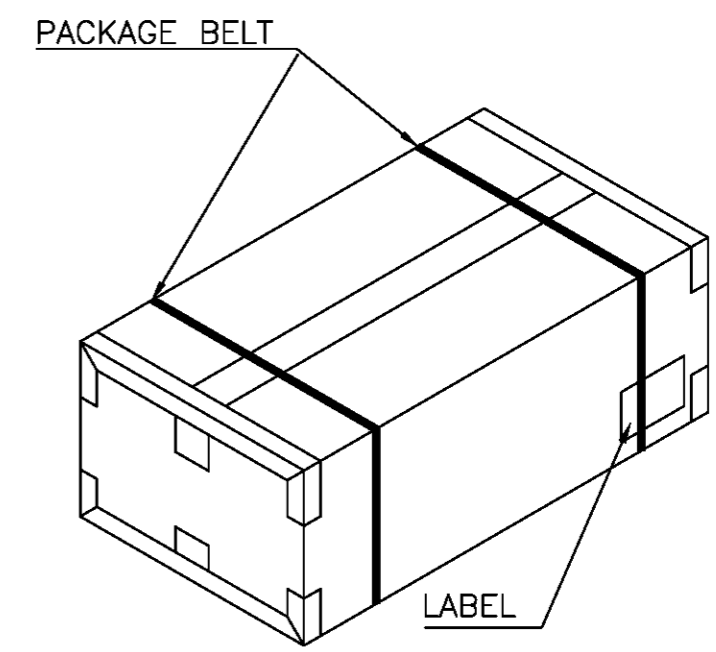
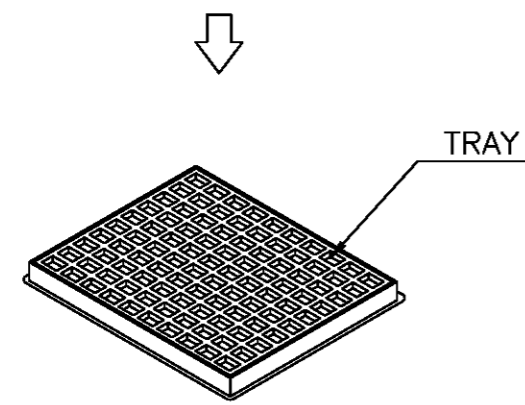
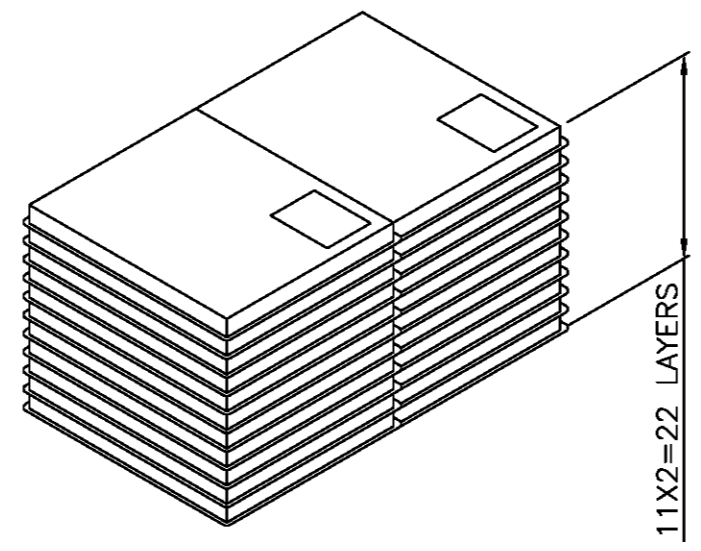
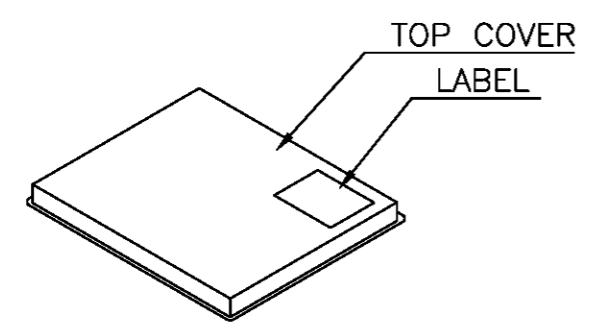

| | | | | | |
|-------------|--------------|------------|----------|---------------|----------|
| 2-1775365-1 | 11.5 KG | 9.5 KG | 100 | 22 | 2200 PCS |
| PART NUMBER | GROSS WEIGHT | NET WEIGHT | PCS/TRAY | TRAYS /CARTON | QUANTITY |

| | | | | | |
|--|--|------------------|--|-----------|------------|
| THIS DRAWING IS A CONTROLLED DOCUMENT. | | DWN | Tyco Electronics Tyco Electronics Corporation Taipei, Taiwan | | |
| DIMENSIONS: MM | | CHK | NAME | | |
| TOLERANCES UNLESS OTHERWISE SPECIFIED: | | APVD | MODULAR JACK, RJ45 SHIELD, SMT TYPE | | |
| 0 PLC ± - | | PRODUCT SPEC | SIZE | CAGE CODE | DRAWING NO |
| 1 PLC ± - | | APPLICATION SPEC | A3 | 00779 | C=1775365 |
| 2 PLC ± - | | WEIGHT | RESTRICTED TO | | |
| 3 PLC ± - | | CUSTOMER DRAWING | SCALE | | |
| 4 PLC ± - | | | SHEET 3 of 3 | | |
| ANGLES ± - | | | REV E1 | | |
| MATERIAL | | | | | |
| FINISH | | | | | |